

**PN : BJHCS-PS5**

**IPN = 5A - 6A - 10A - 15A - 25A**

### Features

- Closed loop
- High accuracy
- Very good linearity
- Low response time
- Low power consumption
- Good over-current capability
- Supply voltage : +5V DC
- Voltage output
- Small PCB mounting
- Can be customized

### Applications

- Frequency drive control home appliances
- Solar power management system
- Inverter applications
- Uninterruptible power supplies (UPS)
- Current monitoring



### ELECTRICAL DATA

BJHCS-PS5-...	05A	06A	10A	15A	25A
Nominal rms current $I_{PN}$ (A)	5	6	10	15	25
Sensed current range $I_{PM}$ (A)	±16	±19,2	±32	±48	±80
Coils turns ration $K (P^y:S^y)$	2:1600	2:1920	1:1600	1:1200	1:1000
Sampling resistor $R_M$ ( $\Omega$ )	100	100	100	50	25
Rated output voltage $V_O$ (V)	$V_{OE} \pm 0,625$				
Supply voltage $V_C$ (Vdc)	$+5 \pm 5\%$				
Static current consumption $I_C$ (mA)	12				

### ACCURACY DYNAMIC PERFORMANCE

### GENERAL & ISOLATION CHARACTERISTICS

Total accuracy	± 0,7	%	Operating temperature	-40 to +85	°C
Zero offset voltage $V_{OE}$ @ $I_P=0, T=25^\circ C$	$2,5^{\pm 0,02}$	V	Storage temperature	-40 to +125	°C
Offset voltage drift $V_{OE}$ @ - 40°C to 85°C	$\leq \pm 0,5$	mV/°C	Weight	12	g
Linearity error $\epsilon_L$	$\leq 0,1$	%FS	Insulation voltage (50Hz, 1mn)	2,5	KV
di/dt accurately followed	> 50	A/ $\mu s$			
Response time $t_r$	$\leq 500$	ns			
Bandwidth (- 1db)	DC to 200	kHz			

## DIMENSIONS

- 1: Out
- 2: +15V
- 3: -15V
- 4: 0V
- 5: - In
- 6: +In

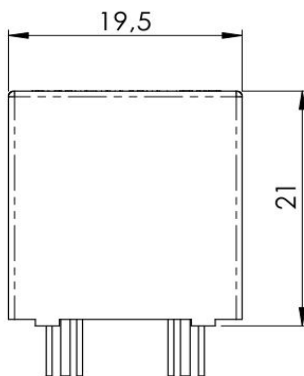
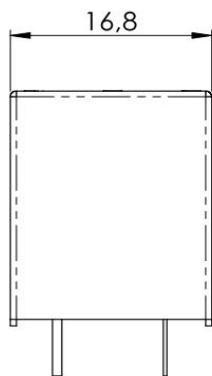
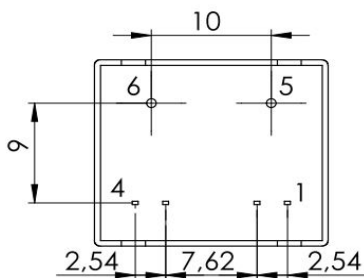

## MECHANICAL CHARACTERISTICS

BJHCS-PS5-...	05A	06A	10A	15A	25A
Input pin (mm)	Ø1,0	Ø1,0	Ø1,0	Ø1,0	Ø1,4
Terminal connection	4 pins, size 0,25 mm x 0,5 mm				
General tolerance	± 0,2 mm				

### BJHCS-PS5-25A : Relation between Input Current and Output voltage :

Input current (A)	- 80	- 75	- 50	- 25	0	25	50	75	80
Output voltage (V)	0,5	0,625	1,25	1,875	2,5	3,125	3,75	4,375	4,5

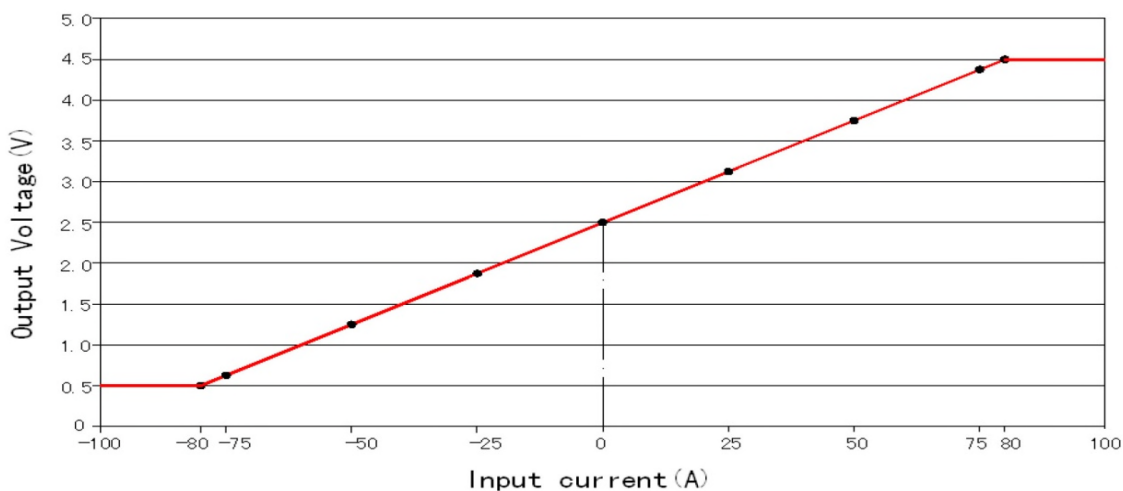

WARNING : Incorrect wiring may cause damage to the sensor.



**Tech Power Electronics**

ZI Les Plaines - 39570 Courlaoux - France - Tel: +33 (0)3 84 25 26 26 - Fax: +33 (0)3 84 35 26 10



**Tech Power**  
Components

[www.techpowerelectronics.com](http://www.techpowerelectronics.com)

**Tech Power**  
Railways® 2